



HOW TO CHANGE YOUR PHONE SETTINGS WHILE ROAMING

NOKIA LUMIA
920/720/520

1



Search for and choose a network manually



From the home screen swipe left to reveal the menu page

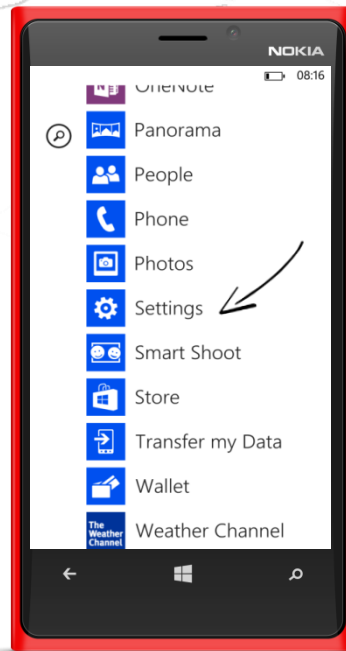

Scroll down and click settings

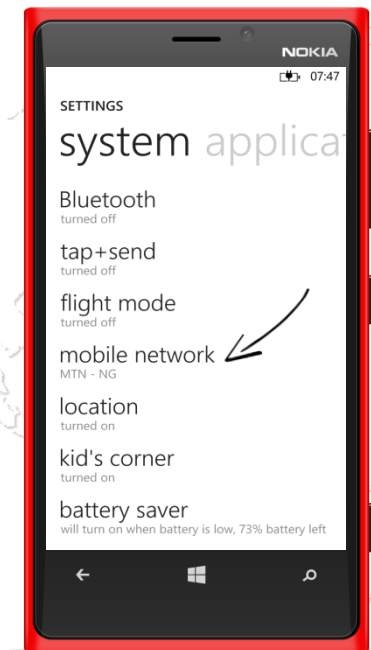

Click mobile network

**NOKIA LUMIA
920/720/520**

1



Search for and choose a network manually

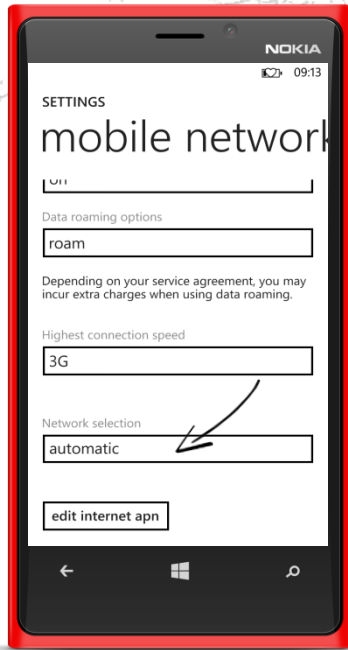

Click on Network Selection to start a search

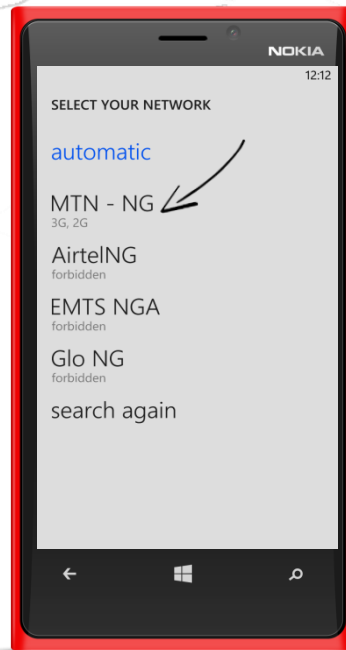

A list of available networks is displayed click on your preferred roaming network to start using it



Changing Access Point Name (APN)



From the home screen swipe left to reveal the menu page

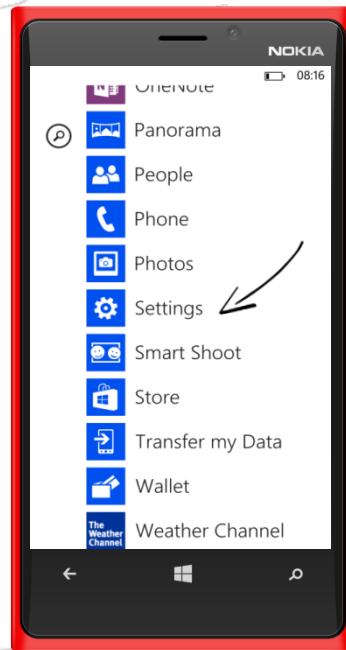

Scroll down and click settings

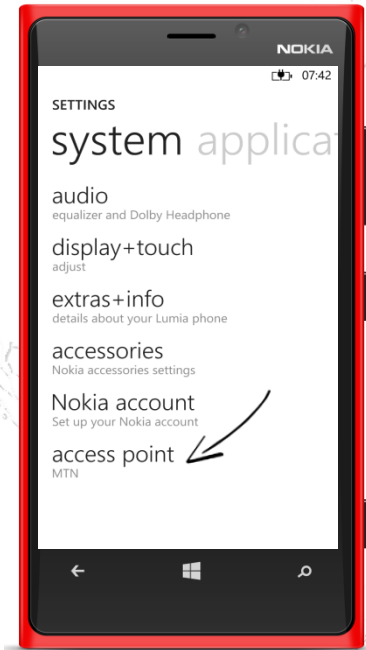

Scroll down and click access point

Changing Access Point Name (APN)



Click add to put in settings for the new network

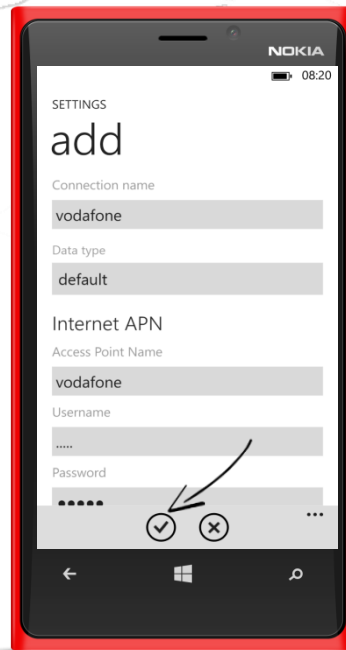

Click the done icon to save the new settings

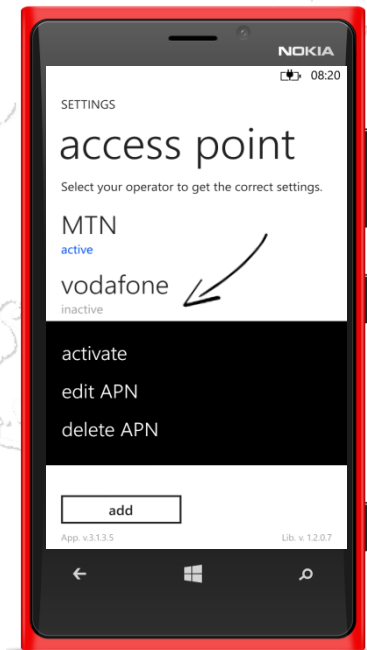

Tap on the new APN to reveal a drop down button. Click activate to start using the new APN

**NOKIA LUMIA
920/720/520**

3



Select between 2G and 3G networks



From the home screen swipe left to reveal the menu page

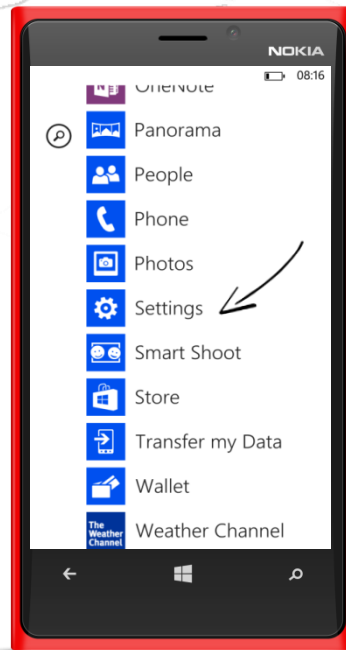

Scroll down and click settings

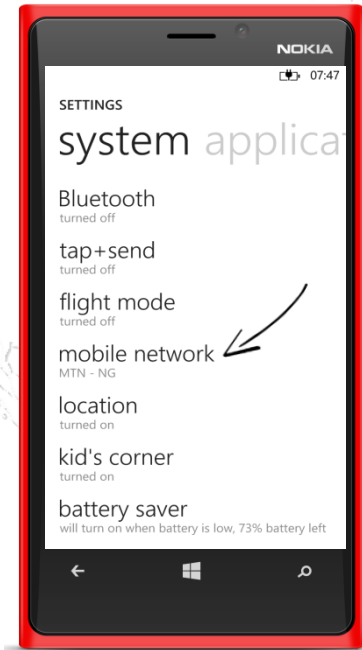

Click mobile network

Select between 2G and 3G networks

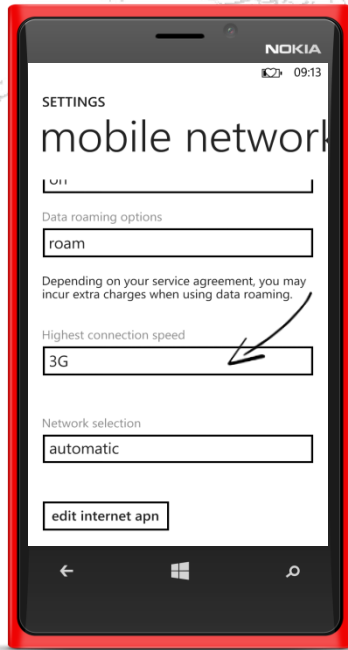

Click on Highest connection speed to reveal a drop down

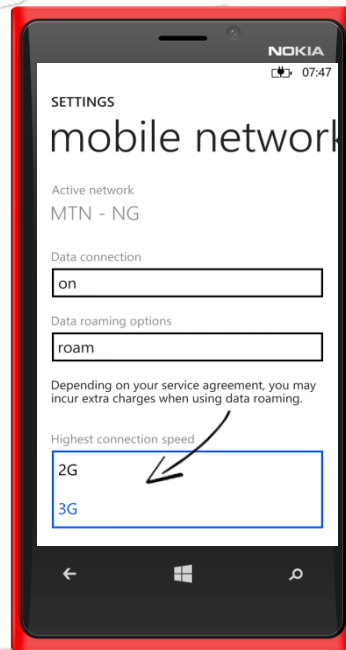

Click on your preferred network speed to activate and use it